

GASOLINE BRUSH CUTTER

52CC



- Before using, please read this manual carefully to understand the use of your unit.
- Keep this manual handy.

SYMBOL EXPLANATION



WARNING ! Clearing saws, Brush cutters and trimmers can be dangerous ! Careless or incorrect use can result in serious or fatal injury to the operator or others



Always wear approved protective gloves.



Read through the Operator's Manual carefully and understand the content before using the machine.



Use anti-slip and stable boots



Always use

- A protective helmet where there is a risk of falling objects
- Ear protection
- Approved eye protection.



Keep body away from hot parts of the engine. Avoid contact during the immediately after operation.



The operator of the machine shall ensure, while working, that no persons or animals come closer than 15 meters.



Fuel and oil mixture.



Keep exhaust area clear of flammable debris. Do not run the engine indoors or where there is poor ventilation. Engine fumes contain deadly poisonous carbon monoxide.



Keep body away from blade or trimmer head.



Do not smoke or allow smoking near fuel or the machine or while using the machine.



Engine stop position.



Engine run position.

CONTENTS

SYMBOL EXPLANATION

Symbols.....	2
--------------	---

CONTENTS

List of contents.....	3
-----------------------	---

SAFETY INSTRUCTIONS

Personal protective equipment.....	4
------------------------------------	---

The machine's safety equipment.....	4
-------------------------------------	---

Control and service of the machine's safety equipment.....	5
--	---

Cutting equipment.....	6
------------------------	---

General safety instructions.....	7
----------------------------------	---

General working instructions.....	8
-----------------------------------	---

Adjusting the harness and clearing saw.....	8
---	---

WHAT IS WHAT

What is on the grass trimmer / brush cutter.....	9
--	---

ASSEMBLY

Assembling the D-handle.....	10
------------------------------	----

Assembly of the blade.....	10
----------------------------	----

Assembling the debris shield.....	10
-----------------------------------	----

Assembling the U-handle.....	11
------------------------------	----

Assembling other guard and cutting equipment.....	11
---	----

Connecting throttle cable and stop switch wires.....	11
--	----

Assembling the trimmer head.....	11
----------------------------------	----

Assembling the main shaft.....	11
--------------------------------	----

FUEL HANDLING

Fuel mixture.....	12
-------------------	----

Fuelling.....	12
---------------	----

START AND STOP

Control before starting.....	13
------------------------------	----

Start and stop.....	13
---------------------	----

MAINTENANCE

Carburetor.....	14
-----------------	----

Muffler.....	14
--------------	----

Cooling system.....	15
---------------------	----

Air filter.....	15
-----------------	----

Drive shaft.....	15
------------------	----

Angle gear.....	15
-----------------	----

Maintenance schedule.....	16
---------------------------	----

Technical data.....	17
---------------------	----

Explosion chart.....	18
----------------------	----

Parts catalogue.....	19
----------------------	----

Parts catalogue.....	20
----------------------	----

SAFETY INSTRUCTIONS

Personal protective equipment IMPORTANT INFORMATION

- A brush cutter or trimmer used incorrectly or carelessly can become a dangerous tool, that can cause serious or fatal injury to the operator or others. It is extremely important that you read and understand the content of this manual.
- When using a brush cutter, or trimmer, personal protective equipment approved by the appropriate authorities must be used. Personal protective equipment does not eliminate the risk of accidents, however, it can reduce the effects of an injury in the event of an accident. Ask your dealer for help when choosing protective equipment.



WARNING !

Remove your hearing protection as soon as you stop the engine, so that you can hear any noises or warning signals.

EAR PROTECTION Ear protection offering sufficient dampening effect should be used.

EYE PROTECTION Blows from branches or objects thrown by the rotating cutting equipment can damage the eyes.

GLOVES Should be worn when necessary, e.g. when assembling cutting equipment.

BOOTS Use anti-slip and stable boots.

CLOTHING Wear clothes made of a strong fabric and avoid loose clothing that can catch on shrubs and branches. Always wear heavy duty long pants. Do not wear jewellery, shorts, sandals or go barefoot. Secure hair so it is above shoulder level.

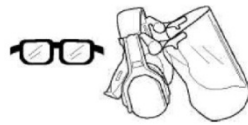

FIRST AID KIT A first kit should be carried by operators of brush cutters, or trimmers.

The machine's safety equipment

This section describes the machine's safety equipment, its function and how checks and maintenance are carried out to ensure that it operates correctly. (See the chapter "What is what" to locate where this equipment is positioned on your machine.)



WARNING

Never use a machine with defective safety equipment. Follow the control, maintenance and service instructions described in this section.

1. Throttle trigger lock

The throttle trigger lock is designed to prevent the throttle from accidentally being engaged. When the trigger lock (A) is pressed into the handle (=when you hold the handle) the throttle (B) is released. When the grip on the handle is released the throttle and the throttle trigger lock return to their original positions. This takes place via two independent return spring system. This means that the throttle is automatically locked in its "idling" position.

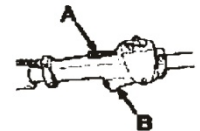

2. Stop switch

The stop switch should be used to stop the engine.

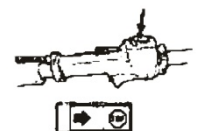

3. Debris shield

This debris shield is intended to prevent objects from being thrown towards the operator and to protect the operator from unintentional contact with the cutting attachment.



WARNING Under no

circumstances may the cutting equipment be

used without an approved debris shield fitted.

Control and

1. Throttle trigger lock

- Check that the throttle is locked in the “idling position” when the throttle trigger lock is in its original position.
- Press in the throttle trigger lock and make sure it returns to its original position when released.
- Ensure that the throttle and throttle trigger lock move easily and that their return spring systems function.
- See section “Start”, start the machine and apply full throttle . Release the throttle and check that the cutting equipment stops and remains at a standstill. If the cutting equipment rotates with the throttle in the idling position then the carburetor’s idling setting must be checked.

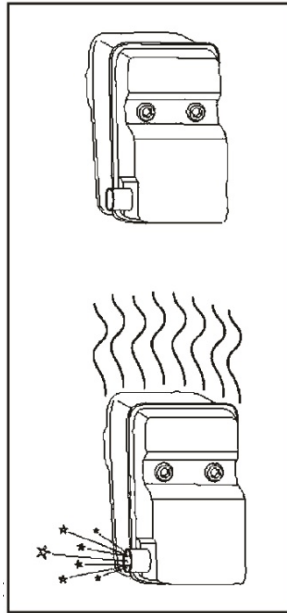

2. Stop switch

Start the engine and make sure that the engine stops when the stop switch is moved to the stop.

3. Debris shield

Check that the shield is undamaged and not cracked.

Replace the shield if it has been exposed to impact or is cracked.

Always use the prescribed blade and shield combination.

4. Blade and Trimmer head

- (1) Grass blades are intended for brush cutting.
- (2) The trimmer head is intended for trimming grass.

service of the Machine’s safety

equipment

5. Locking nut

A locking nut is used to secure some types of cutting equipment on the output shaft.

6. Muffler

The muffler is designed to give the lowest possible noise level and to direct the engine’s exhaust fumes away from the operator.

In countries that have a warm and dry climate the risk of fire is obvious. We have therefore fitted certain mufflers with a spark arrestor screen. Make sure that your muffler is fitted with this kind of screen.

It is extremely important that the instructions for checking maintaining and servicing the muffler are followed.

6. Cutting equipment

This section describes how through correct maintenance and through using the right type of cutting equipment you can:

- Reduce the machine’s tendency to kickback
- Obtain maximum cutting capacity.

Increase the service life of the cutting equipment

The three basic rules:

- (1) Only use the cutting and guard equipment we recommend .
- (2) Keep the blade’s teeth well and correctly sharpened .
- (3) Check the cutting equipment with regard to damage and crack formation. Damaged cutting equipment should always be replaced.

Cutting equipment

The section describes how through correct maintenance and through using the right type of cutting equipment you can reduce the machine's tendency to kickback, obtain maximum clearing capacity and increase the service life of the cutting equipment.

- Only use the cutting and guard equipment we recommend.
- Refer to the instructions for the cutting equipment for the correct winding of cord and for the selection of the right cord diameter.
- Keep to the blade's teeth well and correctly sharpened. Follow our recommendations. Also refer to the instructions on the blade packaging.



WARNING

Incorrect cutting equipment or and incorrectly sharpened blade increases the risk of kickback.

Filing the grass blade

See the cutting equipment's packaging for correct filing instructions.

The blades are sharpened using a single cut flat file.

Sharpen all edges equally to maintain the balance of the blade.

Trimmer head

Only use a trimmer head and trimmer cord that is recommended. These have been tested by the manufacturer to suit a particular engine size. This is especially important when a fully automatic trimmer head is used. Only use the cutting equipment we recommend.

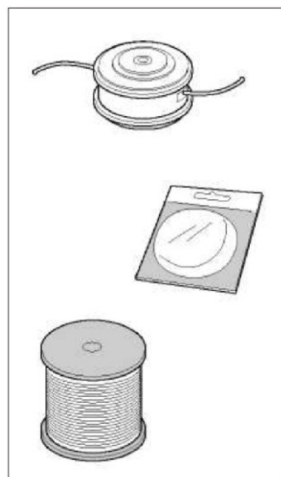

Generally smaller machines require a small trimmer head and vice versa. This is because when clearing using a cord the engine must throw out the cord radially from the trimmer head and also meet resistance from the grass being cleared.

The length of the cord is also important. A longer cord requires greater engine power than a shorter cord of the same diameter.

Make sure the knife positioned on the trimmer guard is intact. This is used to cut the cord to the correct length.

To increase the life of the cord it can be soaked in water for a few days. This will make the line tougher and it will keep longer.

IMPORTANT INFORMATION

Always ensure the trimmer cord is wound tightly and evenly around the drum, otherwise harmful vibrations will occur.

WARNING

Always stop the engine before starting work on any part of the cutting equipment. This continues to rotate even after the throttle has been released. Ensure that the cutting equipment has stopped completely and remove the cable from the spark plug before you start to work on it.



General safety instructions

- The machine is only designed for trimming grass and brush cutting.
- The only accessories to be used with the engine unit as a drive source are the cutting units we recommend in the chapter "Technical data".
- Never use the machine if you are tired, if you have consumed alcohol, or if you are taking medicines that can affect your sight, your judgement or the control of your body.
- Use personal protective equipment. See the section "Personal protective equipment".

- Never use a machine that has been modified so that it no longer corresponds with the original design.
- Never use a machine that is faulty. Follow the maintenance, control and service instructions in this Operator's Manual. Some maintenance and service actions should be carried out by trained and qualified specialists. See the chapter "Maintenance".
- All covers and guards must be fitted before starting the machine. Check that the spark plug cap and HT lead are not damaged, otherwise you could get an electric shock.
- The machine operator shall ensure, while working, that no persons or animals come closer than 15 meters. When several operators are working in the same area the safety distance should be at least double tree length, however, at least 15 meters.



WARNING

Faulty cutting equipment or an incorrectly sharpened blade increases the risk of accidents.



WARNING

When the engine is started with the choke in either the choke or start throttle positions the cutting equipment starts to rotate immediately.

The complete gear housing with shaft must be fitted before the machine is started, otherwise the housing can become loose and cause personal injury. Never start the machine indoors. Bear in mind the dangers of inhaling the engine's exhaust fumes. Observe your surroundings and make sure that there is no risk of people or animals coming into contact with the cutting equipment. Put the machine on the ground, ensure the cutting equipment runs free of twigs and stones. Push the machine body towards the ground using your left hand. (NOTE! Not with your foot). Grip the starter

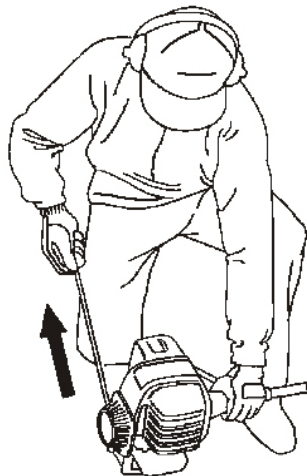

handle with your right hand and pull the starter cord.

Fuel safety

- Always use a fuel container with an anti-spill valve.
- Never fill the machine while the engine is running. Always stop the engine and let it cool for a few minutes before refueling.
- Provide good ventilation when filling or mixing fuel (petrol and 2-stroke oil).
- Move the machine at least 3m from the filling position before starting.
- Never start the machine:

(a) If you have spilt fuel

on it. Wipe up all spillage.

(b) If you have spilt fuel on yourself or your clothes. Change your clothes.

(c) If there is a fuel leak. Make regular checks for leakage from the fuel cap and the fuel supply pipes.

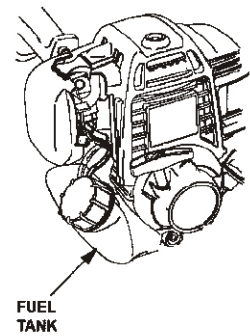

Min 3 m



Transport and storage

Store and transport the machine and fuel so that any leakage or fumes do not risk coming into contact with sparks or naked flames. For example, electric machines, electric motors, electrical switches / power switches, heaters or the like.

When storing and transporting fuel approved containers intended for this purpose must be used.

When storing the machine for long periods the fuel tank must be emptied. Contact your local petrol station to find out how to dispose of excess fuel.



WARNING

Exercise great care when handling fuel. Bear in mind the risk of fire, explosions and inhaling fumes.



out for any obstacles with unexpected movement (roots, stones, branches, pits, ditches, etc.) Take great care when working on sloping ground.

General working instructions

This section takes up the basic safety precautions for working with the brush cutter and trimmer.

If you encounter a situation where you are uncertain how to proceed you should ask an expert. Contact your dealer or your service workshop.

Avoid all usage which you consider to be beyond your capability.

Before starting you must understand the difference between forestry clearing, brush cutting and grass trimming.

Basic safety precautions

1. Observe your surroundings: To ensure that people, animals or other things cannot affect your control of the machine.

To ensure that the above mentioned do not come into contact with the cutting equipment or objects that can be thrown by the cutting equipment.

NOTE! Never use a machine without the possibility of calling for help in the event of an accident.

2. Avoid usage in unfavourable weather conditions. For example, thick fog, heavy rain, strong winds or extreme cold, etc. To work in bad weather conditions is tiring and can create dangerous situations, for example, slippery surfaces.
3. Make sure you can walk and stand safely. Look

cutter



WARNING

When working with the brush cutter the harness should always be worn. If this is not done, you cannot control the brush cutter safely and this can result in injury to yourself or someone else.

Harness quick disconnection

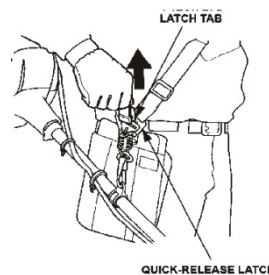

- To quickly detach the harness from the brush cutter, pull the quick-release latch tab upward.

- Insert the latch tongue in the slot of the quick-release latch to reattach the brush cutter to the harness.



WARNING

Always wear protective glasses. Never lean over the guard. Stones, rubbish, etc. can be thrown up into the eyes causing blindness or serious injury. Keep unauthorized persons at a distance. Children, animals, onlookers and helpers should be kept outside the safety zone of 15m. Stop the machine immediately if anyone approaches.

What is what on the grass trimmer

and the brush cutter ?

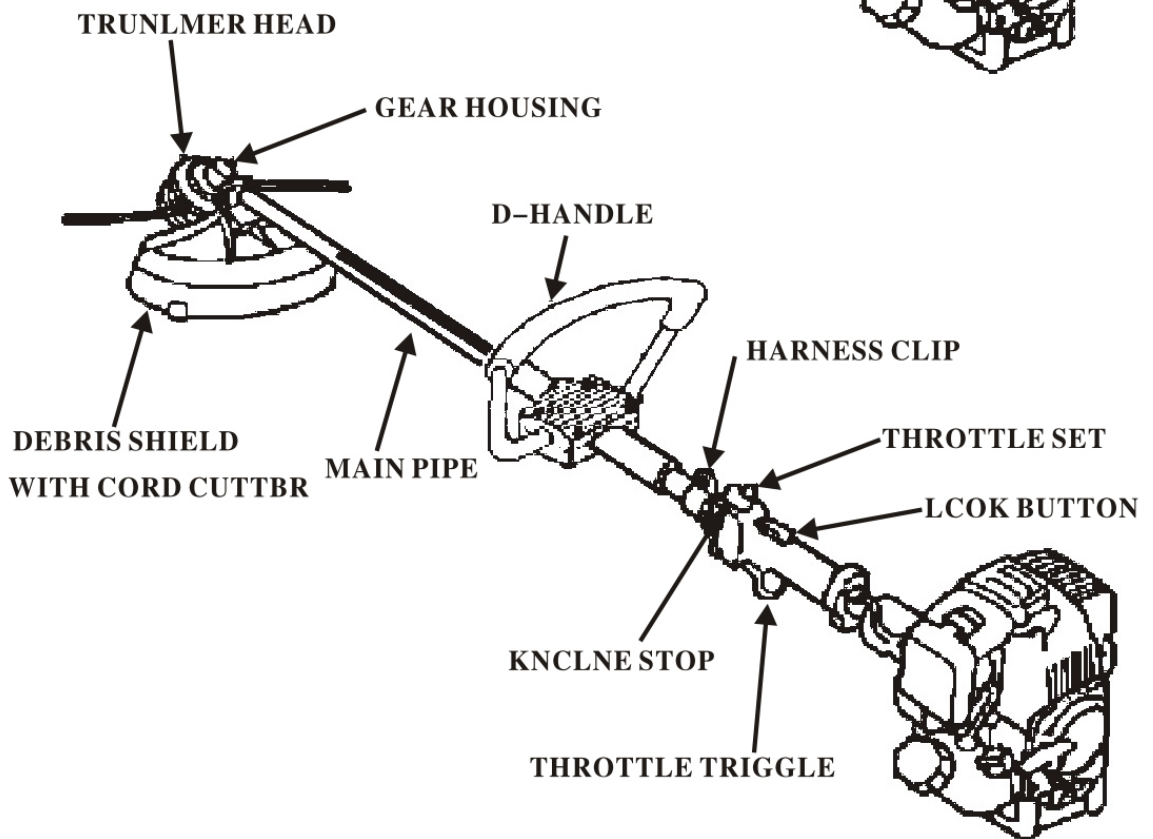
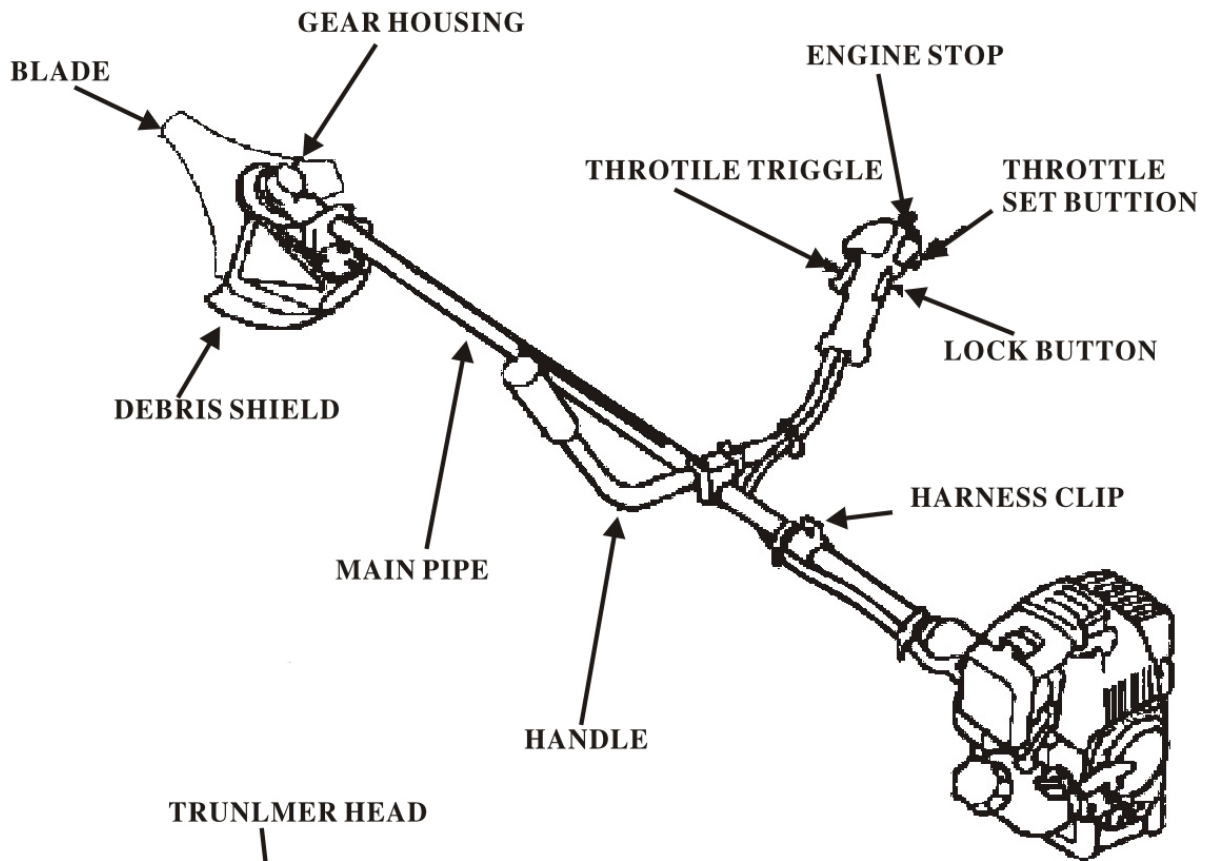

ASSEMBLY

Fit the handle using 4 screws about 30cm in front of the throttle lever on the shaft.

Finely adjust the D-handle to give a comfortable working stance. Tighten the screws.

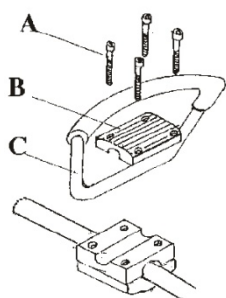

Assembly of the debris shield

It is extremely important that the disc drive's/support flange's guide engages correctly in the cutting equipment's centre hole when assembling the cutting equipment. Cutting equipment assembled incorrectly can result in serious and/or fatal personal injury.



WARNING

Under no circumstances may the cutting equipment be used without an approved shield fitted. If the wrong guard or a defective shield is fitted this can cause serious personal injury.

Assemble debris shield as the fig. illustrated below, note that tighten torque of the bolts is 3.4N .

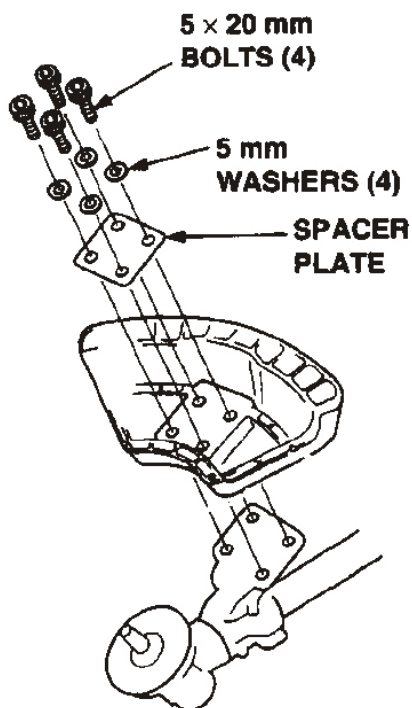

Assembling the blade

Assembling the D-handle

Fit the upper plate (F) and adapter housing (E) to the output axle.

Turn the blade axle until one of the holes in the upper plate aligns with the hole in the gear housing (H).

Insert a locking pin in the hole (H) so that the axle is locked.

Place the blade (D), low plate (C) and plate housing (B) on the output shaft.

Fit the nut (A). The tightening torque of the nut is 35-50Nm (3,5-5kgm). Use the socket spanner in the tools kit. Hold the handle of the spanner as close to the blade guard as possible. The nut is tightened when the spanner is turned against the direction of rotation (left-hand thread).

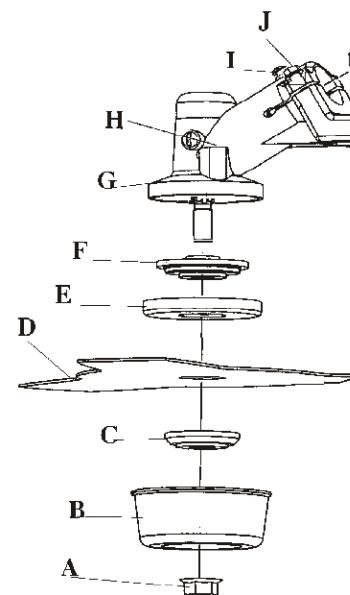

Assembling the debris shield

- (1) Fasten the cord cutter (A) to the shield (C) with a ST3.5X12 SCREW, AS SHOWN.
- (2) Attach the shield extension (B) to the shield bottom.

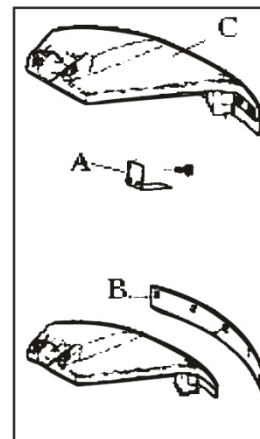

Assembling

the

U-handle

Insert the U-handle bar into the handle holder, making sure that the hole in the handle holder fit in the handle bar.

After the handle bar in place, tighten the four bolts.

Note: Be sure the bolts are tight, but not over tight.

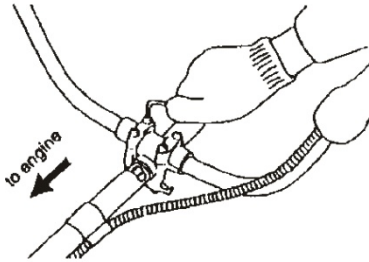

Connecting throttle cable and stop

switch wires

- (1) Insert the throttle cable through the cable adjuster sleeve on the carburetor bracket. Make sure the end of the throttle cable housing is seated positively in the sleeve.
- (2) Position the slotted fitting on the carburetor so the recessed hole (A) is away from the cable adjuster sleeve.
- (3) Rotate the carburetor throttle cam and slip the throttle cable through the slot in the slotted fitting, making sure the cable lug drops into the recessed hole.
- (4) Operate the throttle trigger a few times to make sure that it works correctly.
- (5) Bind the throttle cable and the wires with bands (B).

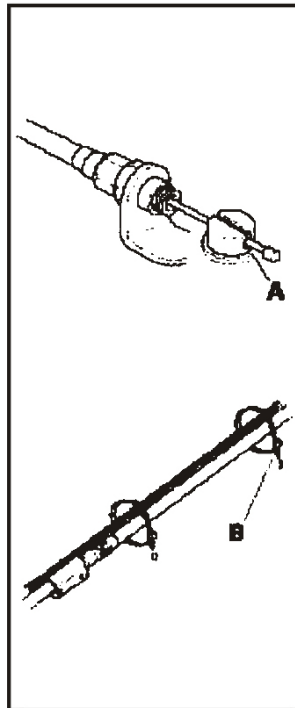

Adjusting the harness

Quick release

On the front is an easily accessible, quick release catch:

- Pull out the red strap
- The hip strap and one shoulder strap will be automatically released at the same time and the harness and the engine unit will slide to the ground.

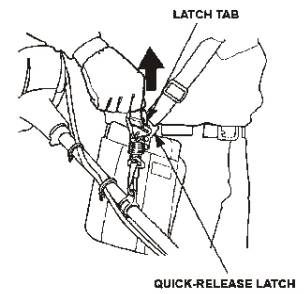

Use this if the engine should catch fire or in any other emergency situation when you quickly need to take off the harness and machine.

Assembling the trimmer head

- A. Fit the upper plate (D) and adapter housing (C) to the output axle.
- B. Turn the blade axle until one of the holes in the upper plate aligns with the hole (F) in the gear housing (E).
- C. Insert a locking pin in the hole (F), so that the axle is locked.
- D. Place the low plate (B) and nylon trimmer head (A) on the output shaft.
- E. Screw on the trimmer head (A) in the direction of rotation.

Assembling the main shaft

Loosen the screw (A) and two bolts (C).

Insert the main shaft tube into the gear housing. Turn the blade axle and push the main shaft tube in until the holes (B) in the main shaft tube aligns with the hole (A) in the gear housing.

Tighten the screw (A) and two bolts (C), so that the main shaft tube is locked.

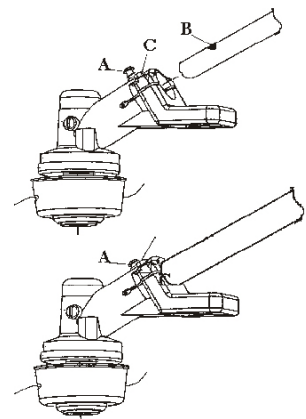

FUEL HANDLING

Fuel mixture

NOTE!

The machine is fitted with a two-stroke engine and must always be run on a mixture of petrol and two-stroke oil. It is important to measure the quantity of oil accurately, to ensure the correct mixture ratio. Small discrepancies in the amount of oil have a great bearing on the proportions of the fuel mixture when mixing small amounts of fuel.



WARNING!

Always provide good ventilation when handling fuel.

Petrol

Always use oil-mixed quality petrol (at least 90 octane). If your machine is equipped with a catalytic converter, (see “technical data”) an unleaded, oil mixed quality petrol should always be used. Leaded petrol will destroy the catalytic converter.

- The lowest recommended octane rating is 90. If you run the engine on petrol with a lower octane rating than 90 so-called “knocking” can occur. This leads to an increased engine temperature, which can result in a serious engine breakdown.
- When working at continuous high revs a higher octane rating is recommended.



Two-stroke oil

- For the best results use high level two-stroke oil. Mixing ratio 1:25 (4%).

- Never use two-stroke oil intended for water cooled outboard motors, so-called outboard motor oil.
- Never use oil intended for four-stroke engines.

Mixture

- Always mix petrol and oil in a clean container intended for petrol.
 - Always start by filling half the quantity of petrol required. Then add the entire oil quantity. Mix (shake) the fuel mixture. Fill the remaining quantity of petrol.
 - Mix (shake) the fuel mixture carefully before filling in the machine’s fuel tank.
- Do not mix more than max, one month’s supply of fuel.
- If the brush cutter is not used for a long period of time, the fuel tank should be emptied and cleaned.

Fuelling



WARNING

The following precautions reduce the risk of fire: Do not smoke or place any sources of heat in the vicinity of the fuel. Never refuel when the engine is running. Always stop the engine and let it cool for a few minutes before refueling. Open the fuel cap slowly when fuelling so that any over pressure is released slowly. Tighten the fuel cap carefully after refueling. Always move the machine from the fuelling place before starting.

Clean around the fuel cap. Contamination in the tank can disrupt operations.

Ensure that the fuel is well mixed by shaking the container before filling the tank.

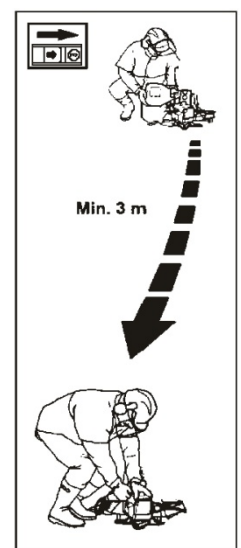

Always use a fuel container with an anti-spill valve.

Gasoline	Oil
	4% (1:25)
5	0.20
10	0.40
15	0.60
20	0.80

START AND STOP

Control before starting

For reasons of safety follow these recommendations

- Check the blade to ensure that no cracks have formed at the bottom of the teeth or by the centre hole. The most common reason why cracks are formed is that sharp corners have been formed at the bottom of the teeth while sharpening or that the blade has been used with dull teeth. Discard a blade if cracks are found.

- Check that the support flange is not cracked due to fatigue or due to being tightened too much. Discard the support flange if it is cracked.

Ensure the locking nut has not lost its captive force. The nut lock should have a locking force of at least 1.5Nm. The tightening torque of the locking nut should be 35-50 Nm.

Check that the guard is not damaged or cracked. Replace the guard if it is exposed to impact or is cracked.

Check that the trimmer head and shield are not damaged or cracked. Replace the trimmer head or shield if they are exposed to impact or are cracked.

Never use the machine without a guard or spray guard not with a defective guard.

Check that the trimmer head and shield are not damaged or cracked. Replace the trimmer head or shield if they are exposed to impact or are cracked.

Never use the machine without a guard or spray guard not with a defective guard.

Start and stop



WARNING

The complete clutch cover with shaft must be fitted before the machine is started,

otherwise the clutch can become loose and cause personal injury. Always move the machine from the filling area before starting. Place the machine on a flat surface. Ensure the cutting equipment cannot come into contact with any object. Make sure no unauthorized persons are in the working area, otherwise there is a risk of serious personal injury. The safety distance is 15 meters.

Cold engine

IGNITION: Set the stop switch to the run position.

CHOKE: Set the choke control in the choke position.

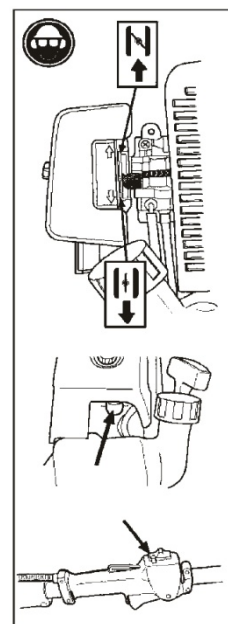

AIR PURGE: Prime with fuel by pressing the diaphragm repeatedly until fuel begins to run back into the tank through the transparent fuel hose.

Warm engine

Use the same starting procedure as for the cold engine, but do not set the choke control in the choke position. Set the throttle to the start position by pressing the throttle trigger and then

pressing the red button next to the stop button.

Stop

Stop the engine by switching the stop switch to the stop setting.



WARNING

When the engine is started with the choke in the choke or start position the cutting equipment starts to rotate immediately.

Start

Press the machine body against the ground using your left hand (NOTE! Not your foot). Grip the starter handle, slowly pull out the cord with your

right hand until you feel some resistance (the starter pawls grip), now quickly and powerfully pull the cord. Reset the choke control as soon as the engine fires and repeat until the engine starts. When the engine starts quickly apply full throttle and the start throttle will automatically disengage. **NOTE!** Do not pull the starter cord out completely and do not release the starter cord from the fully extended position. This can damage the machine.

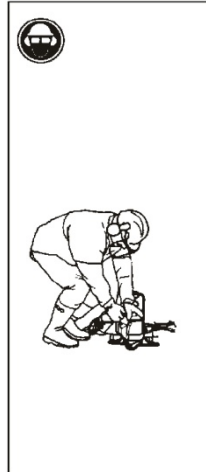

is correct, the trimmer head will not rotate. If adjustment is required, close (clockwise) the T-screw, with the engine running, until the trimmer head starts to rotate (3200rpm).

Open (counterclockwise) the screw until the trimmer head stops. You have reached the correct idle speed (about 2800rpm) when the engine runs

smoothly in all positions well below the rpm when the trimmer head starts to rotate.

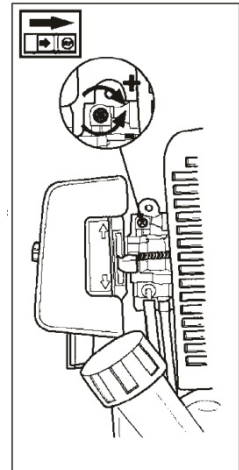

Note: The carburetor adjustment should be carried by qualified specialists.

MAINTENANCE

Carburetor

After your unit has been run 8/10 tanks of fuel the engine has broken in. To ensure that your unit is at peak performance and producing the least amount of harmful emissions after break in, have your authorized servicing dealer, who has a revolution counter at his disposal, to adjust your carburetor for optimum operating conditions.



WARNING

The complete clutch cover with shaft must be fitted before the machine is started, otherwise the clutch can become loose and cause personal injury.



WARNING!

Contact your servicing dealer, if the idle speed setting cannot be adjusted so that the cutting attachment stops. Do not use the machine until it has been properly adjusted or repaired.

NOTE! The machine should only be used for short periods at its highest speed.

Operation

The carburetor governs the engine's speed via the throttle. Air/fuel is mixed in the carburetor. The air/fuel mixture is adjustable. To take advantage of the engine's optimal output the adjustment must be correct.

The setting of the carburetor means that the engine is adapted to local conditions, for example, the climate, altitude, petrol and type of 2-stroke oil.

Idle speed adjustment (T)

Check that the air filter is clean. When the idle speed

necessary. On mufflers fitted with a catalytic

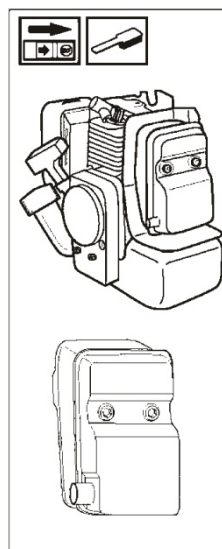

The muffer is designed to dampen the noise level and to direct the exhaust fumes away from the user. The exhaust fumes are hot and can contain sparks, which can result in fire if the exhaust fumes are directed toward a dry and inflammable material. Some mufflers are equipped with a special spark arrestor screen. If your machine is fitted with this type of screen it should be cleaned regularly. This is done using a wire brush. On mufflers without a catalytic converter the screen should be cleaned weekly, or replaced if

converter the screen should be checked monthly. If the screen is damaged it should be replaced.

If the screen is frequently blocked, this can be a sign that the function of the catalytic converter is impaired. Contact your dealer to inspect the muffler. A blocked screen will cause the engine to overheat resulting in damage to the cylinder and piston. Also see under "Maintenance" NOTE! Never use a machine with a defective muffler.

MAINTENANCE

Cooling system

To maintain as low an operating temperature as possible the engine is equipped with a cooling system.

The cooling system consists of:

1. An air intake on the starter unit.
2. Cooling fins on the flywheel.
3. Cylinder cover (leads cold air onto the cylinder). Clean the cooling system using a brush at least once a week, in difficult conditions more often. A dirty or blocked cooling system leads to the engine overheating resulting in damage to the cylinder and piston.

Air filter

The air filter should be cleaned regularly removing dust and dirt to avoid:

- Carburetor malfunction
- Starting problems
- Reduced engine power
- Unnecessary wear to engine parts
- Abnormal fuel consumption

Clean the filter after every 25 hours or more regularly if operating conditions are exceptionally dusty.

Cleaning the air filter

Dismantle the air filter cover and remove the air filter. Wash in clear, warm soapy water. Ensure that

the filter is dry before refitting. An air filter used for a long period of time can never be cleaned completely. Therefore it is necessary to replace the filter from time to time with a new filter. A damaged air filter must always be replaced.

Drive shaft

The drive shaft is lubricated with grease. The shaft must be lubricated at least every 25 working hours. Lift up the locking button that holds the drive shaft sleeve in the clutch cover.

Remove the clip that holds the throttle cable on the drive shaft.

Pull the drive shaft sleeve out of the clutch cover.

Remove the drive shaft from the sleeve either by shaking it out or pulling it out using pliers.

Coat the surface of the shaft with grease from the tube.

Spread it out using a brush or rag.

Slide the drive shaft back into the sleeve. Make sure the shaft engages correctly by turning it and pushing at the same time.

When the shaft is correctly installed in the sleeve the end of the shaft should project about 10mm beyond the edge of the sleeve.

Rotate the shaft and push it in at the same time.

Install the drive shaft sleeve in the clutch cover so that the hole is positioned directly underneath the locking button on the clutch cover.

Angle gear

The angle gear is filled with a sufficient quantity of grease at the factory. However, before using the machine you should check that the angle gear is filled to 3/4 with grease. Normally, the grease does not need to be changed except when the angle gear is repaired.

Maintenance schedule

Below follows some general maintenance instructions. If you need further information please contact your service workshop.

Daily maintenance

1. Clean the outside of the machine.
2. Make sure the harness is not damaged.
3. Make sure the throttle trigger lock and the throttle function correctly from a safety point of view.

4. Check that the stop switch functions.
5. Check that the cutting head does not rotate while idling.

6. Clean the air filter. Replace if necessary.

7. Check the guards for damage and ensure that they are not cracked. Replace the guards if they have been exposed to impact or are cracked.

8. Check that the blade is well centred, is sharp, and is not cracked. An uncentred blade causes vibrations that can result in damage to the machine.

9. Check that the trimmer head is undamaged and not cracked. Replace the trimmer head if necessary.
10. Check that the locking nut is tight.

11. Check that all nuts and screws are tightened.

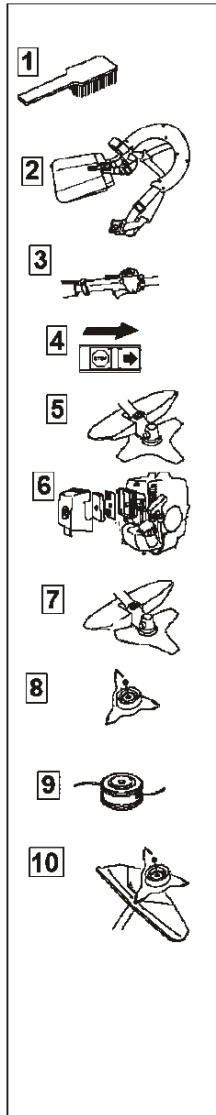

4. Clean the cooling fins on the flywheel.
5. Clean or replace the muffler's spark arrestor screen (not on mufflers with a catalytic converter).

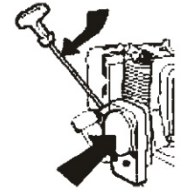

6. Clean the carburetor area.
7. Clean the cooling fins on the cylinder and check that the air intake in the starter unit is not blocked.

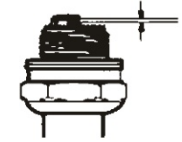

8. Check that the angle gear is 3/4 filled with grease. Fill if necessary using special grease.



Monthly maintenance

1. Clean the fuel tank using petrol.
2. Clean the carburetor and the area surrounding it.
3. Clean the fan and the area around it.
4. Check the fuel filter and the fuel pipe, replace if necessary.
5. Check all cables and connections.
6. Check the clutch, clutch springs and the clutch drum with regard to wear. Replace if necessary.
7. Change the spark plug.

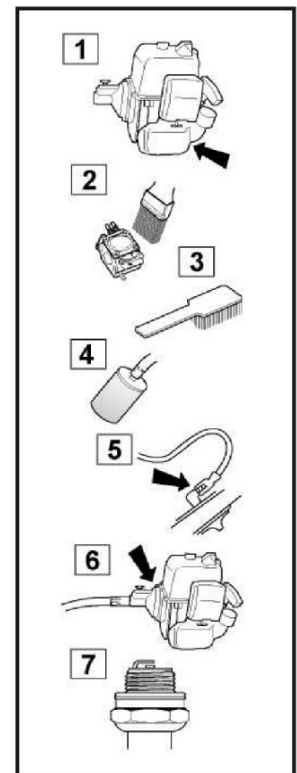

Weekly maintenance

1. Check the starter, the starter cord and the return spring.
2. Make sure that the vibration damping elements are not damaged.
3. Clean the outside of the spark plug. Remove and check the electrode gap. Adjust the gap to 0.6-0.7mm or change the spark plug.

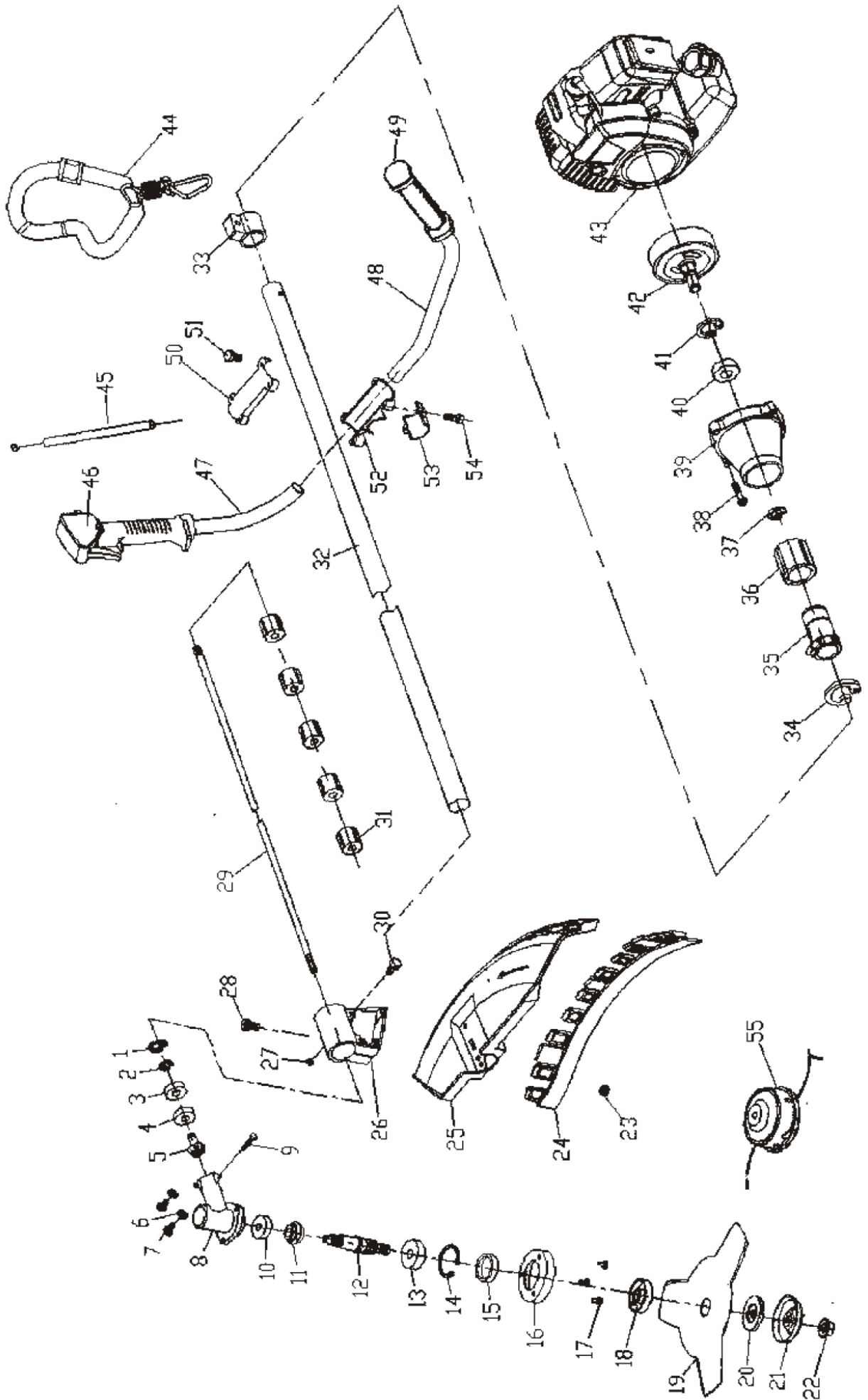

No.	Parts name	Quantity	No.	Parts name	Quantity
1	Retaining Ring	1	29	Screw	4
2	Retaining RING	1	30	Transmission Shaft	1
3	Bearing	1	31	Screw	2
4	Bearing	1	32	Liner	5
5	Gear	1	33	Al-pipe	1
6	Washer	1	34	Hunger Cup	1
7	Screw	2	35	Retaining Ring	1
8	Gear Case	1	36	Rubber Bushing	1
9	Screw	1	37	Rubber Bushing	1
10	Bearing	1	38	Retaining Ring	1
11	Big Gear	1	39	Screw	4
12	Shaft	1	40	Connector For Protection	1
13	Bearing	1	41	Bearing	1
14	Snap Ring	1	42	Retaining Ring	1
15	Retaining Ring	1	43	Hanger Link	1
16	Protection	1	44	Petrol Motor	1
17	Holder For Shaft	1	45	Hunger Cup	1
18	Screw	3	46	Throttle Line	1
19	Adapter Housing	1	47	Right Grip Of Handle	1
20	Blade	1	48	Al-pipe	1
21	Low Plate	1	49	Al-pipe	1
22	Plate Housing	1	50	Left Grip Of Handle	1
23	Nut	1	51	Up Holder	1
24	Screw	4	52	Screw	4
25	Shield Extension	1	53	Localizer Link	1
26	Shield	1	54	Down Holder	1
27	Holder	1	55	Screw	2
28	Screw	2	56	Blade	1

